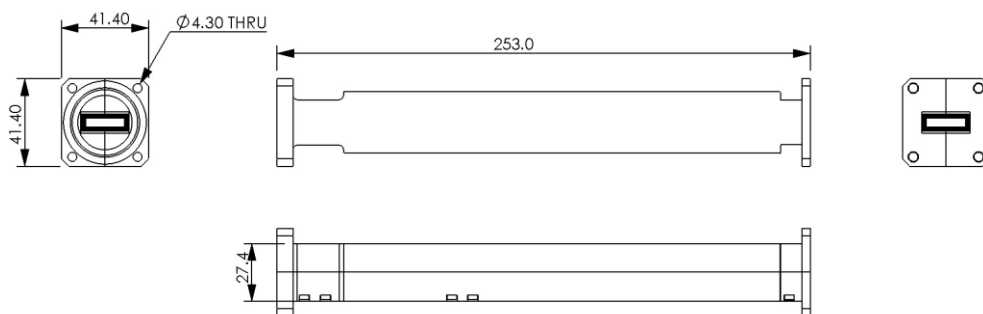

KEY FEATURES

- Low insertion loss
- Excellent return loss
- Good harmonic rejection
- No tune design
- High power handling

This WG16 lowpass filter offers good attenuation over the 2nd, 3rd and 4th harmonic bands together with very low loss passband performance. Alternative flange interfaces are available upon request.

**Interface Control Drawing**

Specification

Model	006395
Passband	9.2 – 9.5 GHz
Passband Insertion loss	< 0.35 dB (< 0.25 dB typical)
Passband Return loss	> 23 dB
Rejection, 18.4 – 19.0 GHz (2 nd Harmonic)	> 30 dB (> 60 dB typical)
Rejection, 27.6 – 28.5 GHz (3 rd Harmonic)	> 30 dB
Rejection, 36.8 – 38.0 GHz (4 th Harmonic)	> 30 dB
Power Handling (Peak)	4 kW (@0.1% duty cycle)

Environmental

Temperature Range	-40°C to +85°C
-------------------	----------------

Mechanical

Interface	UBR 100/CBR 100 Flanges
Interface Control Drawing	006395-ICD
Material	Ag Plated Aluminium
Paint Finish	Semi-gloss black

Note: All information is correct at date of issue. Specifications are subject to change without notice
Issued: 05/10/21
Revision: 01

Measured Performance

